

**INDEX**

- TRANSFORMER - (T)
- WATER SUPPLY - (W)
- DRAIN LINE - (D)
- SEPTIC TANK - (ST)
- BORING POINT - (BP)
- PUMP HOUSE - (PH)
- WATER HARVESTING - (WH)
- KHASRA BOUNDARY LINE - (KB)
- CULVERT - (C)
- GARBAGE COLLECTION POINT - (GCP)
- ELECTRIC POLES - (EP)

**EXISTING LAYOUT PHASE-IV (SWARNIMA ERA)**  
 GYAPAN NO. :- 2287  
 DATE :- 08/07/2022

विकास अनुबा अनुमोदित केवल 3-1-2022/15 प्रयोजन के वेपता तिथि 12/3 दिनांक 2/11/2022 अनुबा पत्र क्रमांक 12/3 दिनांक 2/11/2022

**PROPOSED SERVICE PLAN**

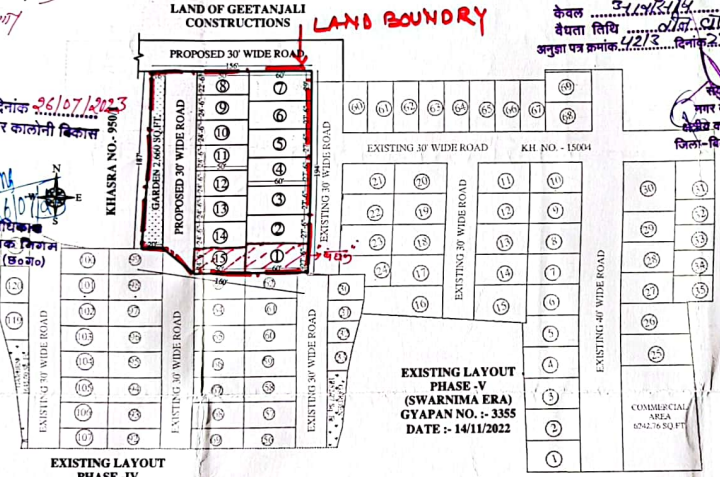

**PROPOSED LAYOUT PLAN**

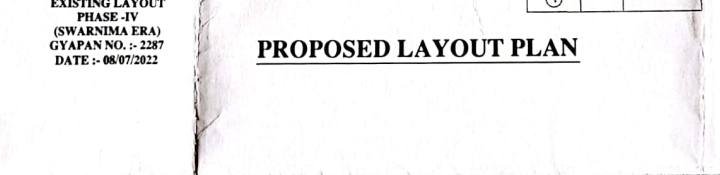

KHASRA AREA DETAIL			
SR. NO.	KHASRA NO.	AREA (HECT.)	AREA (ACRE)
1	950/2	0.247	0.61
TOTAL		0.247	0.61

**M/S BDA GROUP**  
BILASPUR

**AREA STATEMENT**

- 1) TOTAL PLOT AREA = 26,596.00 Sq.ft.
- 2) GARDEN AREA = 2,660.00 Sq.ft. (10.00 % Of '1')
- 3) PLOTTED AREA = 21,340.00 Sq.ft. (80.24 % Of '1')
- 4) ROAD AREA = 2,596.00 Sq.ft. (9.76 % Of '1')

**PLOT AREA DETAIL**

PLOT NO.	AREA (SQ.FT.)
1	1650
2	1650
3	1650
4	1650
5	1650
6	1650
7	1740
8	1125
9	1225
10	1225
11	1225
12	1225
13	1225
14	1225
15	1225
TOTAL	21340

AREA= 21,340.00 SQ. FT.

**OWNER'S NAME & ADDRESS**

PROPOSED RESIDENTIAL LAYOUT PLAN FOR M/S BDA GROUP,  
 P.H.No. - 25,  
 KH.No. - 950/2,  
 TOTAL AREA- 0.61 ACRE,  
 AT Village KHAMTRAI,  
 Dist. BILASPUR (C.G.)

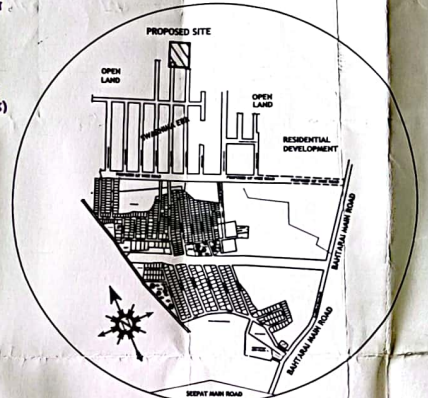

**LOCATION PLAN**

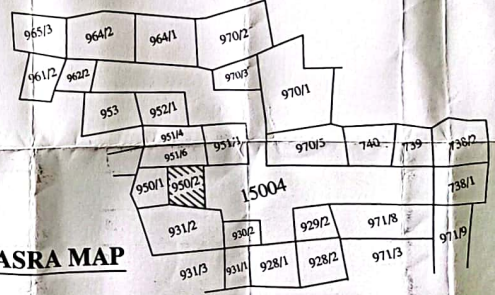

**KHASRA MAP**

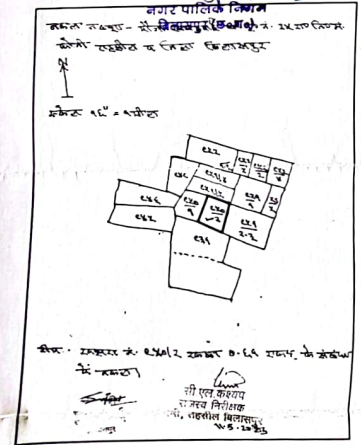

**SUPER IMPOSE KHASRA MAP**

**OWNER'S SIGN**

For, M/s. BDA GROUP  
 Partner

**ARCHITECT/ TOWN PLANNER**

**AR. AVINASH SAHU**  
 CA/2020/120269  
 REG. NO. - 463  
 BILASPUR (C.G.)

DATE	SCALE	DEALT BY
19-05-2023	1"=60'	AVINASH